

FOR LEASE

2449 CADES WAY, SUITE D, VISTA, CA



PROPERTY DETAILS

- An Approximate 4,200 SF Industrial Suite on Quiet Cul-De-Sac
- 2 Restrooms
- Treated and Coated Concrete Floors
- Balance Warehouse
- Over 20' Clear Height
- 100% Climate Controlled
- Fire Sprinklers
- 2" Gas Service
- Outdoor Patio Area in Front
- Previously Approved For Public Occupancy
- Power: 200 AMPS, 208v, 3-Phase
- Skylights and New Solarcool Roof
- Grade Door with Drive Around Access
- Owner Can Build Additional Office if Required
- Cam is \$.17 PSF
- Excellent Location with Easy Access to 78 Freeway and Palomar Airport Road

LEASE RATE - \$1.60 PSF MG

SAN DIEGO COMMERCIAL

TIM CLEPPER - PRESIDENT
380 S. MELROSE DR., SUITE 367, VISTA CA 92081
TIM@SANDIEGOCOMMERCIAL.INFO
WWW.SANDIEGOCOMMERCIAL.INFO
CA DRE BROKER LICENSE #: 01354303
C: 760.402.4846 T: 760.599.4200 F: 760.599.4344

FOR LEASE

2449 CADES WAY, SUITE D, VISTA, CA

FLOOR PLAN

SUITE D
4,200 SF

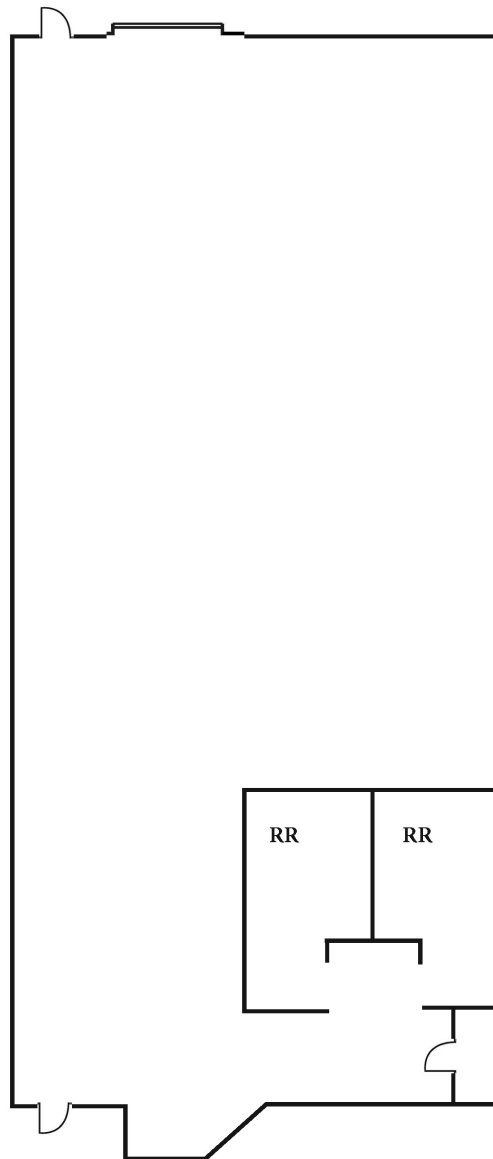

LEASE RATE - \$1.60 PSF MG

SAN DIEGO COMMERCIAL

TIM CLEPPER - PRESIDENT
380 S. MELROSE DR., SUITE 367, VISTA CA 92081
TIM@SANDIEGOCOMMERCIAL.INFO
WWW.SANDIEGOCOMMERCIAL.INFO
CA DRE BROKER LICENSE #: 01354303
C: 760.402.4846 T: 760.599.4200 F: 760.599.4344