

FOR LEASE OR SALE

2221 LAS PALMAS DRIVE, UNITS I & J, CARLSBAD, CA



PROPERTY DETAILS

- Two Condo Units Totaling Approximately 6,589 SF
- Suite I - Approximately 3,652 SF
- Suite J - Approximately 2,917 SF
- Approximately 40% Office
- Corner Unit with Reception, 9 Offices, Conference Room
- Three Restrooms and Kitchen
- Two Grade-Level Roll-up Doors (10'x12')
- Gas to Building
- Drive Around Access
- Professionally Managed Association



SALE PRICE - \$2,141,000
LEASE RATE - \$1.30 (MG) PSF

RUSS JABARA - VICE PRESIDENT
RUSS@SANDIEGOCOMMERCIAL.INFO
CA DRE SALES LICENSE #: 01315296
C: 760.822.4851

SAN DIEGO COMMERCIAL

TIM CLEPPER - PRESIDENT
TIM@SANDIEGOCOMMERCIAL.INFO
CA DRE BROKER LICENSE #: 01354303
C: 760.402.4846 T: 760.599.4200

WWW.SANDIEGOCOMMERCIAL.INFO

FOR LEASE OR SALE

2221 LAS PALMAS DRIVE, UNITS I & J, CARLSBAD, CA

FLOOR PLAN

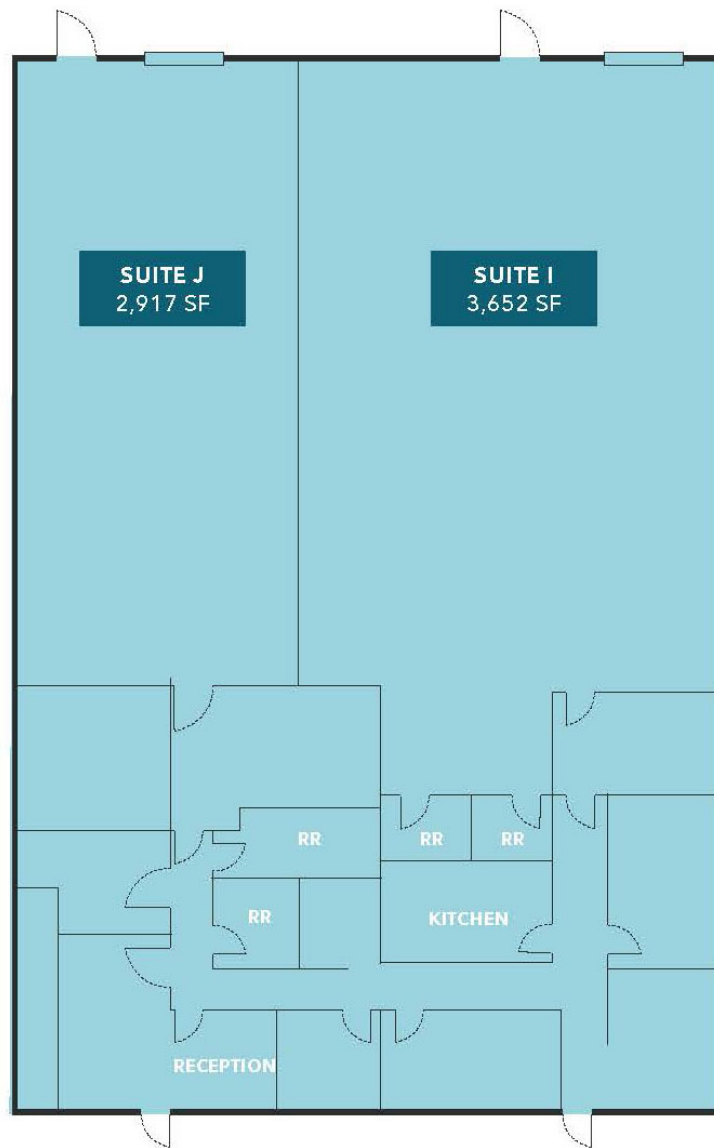

SALE PRICE - \$2,141,000

LEASE RATE - \$1.30 (MG) PSF

RUSS JABARA - VICE PRESIDENT
RUSS@SANDIEGOCOMMERCIAL.INFO
CA DRE SALES LICENSE #: 01315296
C: 760.822.4851

SAN DIEGO COMMERCIAL

TIM CLEPPER - PRESIDENT
TIM@SANDIEGOCOMMERCIAL.INFO
CA DRE BROKER LICENSE #: 01354303
C: 760.402.4846 T: 760.599.4200

WWW.SANDIEGOCOMMERCIAL.INFO

FOR LEASE OR SALE

2221 LAS PALMAS DRIVE, UNITS I & J, CARLSBAD, CA

UNIT I = 3,652 SF

UNIT J = 2,917 SF

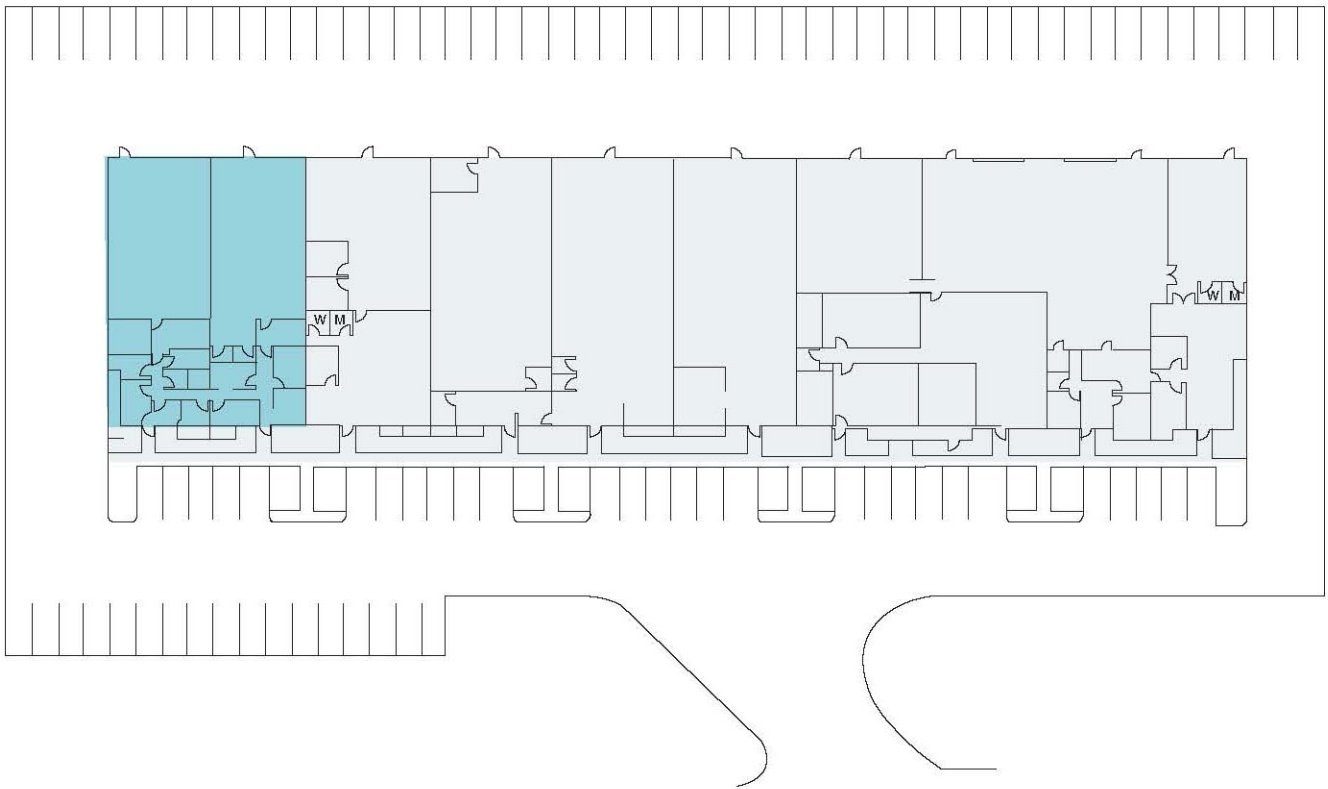

SALE PRICE - \$2,141,000
LEASE RATE - \$1.30 (MG) PSF

RUSS JABARA - VICE PRESIDENT
RUSS@SANDIEGOCOMMERCIAL.INFO
CA DRE SALES LICENSE #: 01315296
C: 760.822.4851

SAN DIEGO COMMERCIAL

TIM CLEPPER - PRESIDENT
TIM@SANDIEGOCOMMERCIAL.INFO
CA DRE BROKER LICENSE #: 01354303
C: 760.402.4846 T: 760.599.4200

WWW.SANDIEGOCOMMERCIAL.INFO