

JUST LEASED

1020 LINDA VISTA DR., #A, SAN MARCOS, CA



PROPERTY DETAILS

- An Approximate 10,860 SF Suite in an Industrial Building
- Single Story Building with 1,800 SF of Office
- Bonus Mezzanine - 3,702 SF
- Rare Yard Allowing for Outside Storage
- IL Zoning
- 3 Oversized Grade Level Doors
- 22 Parking Spaces
- Heavy Power
- 5'-17' Clear Height
- Quick Access to Highway 78
- Represented Tenant

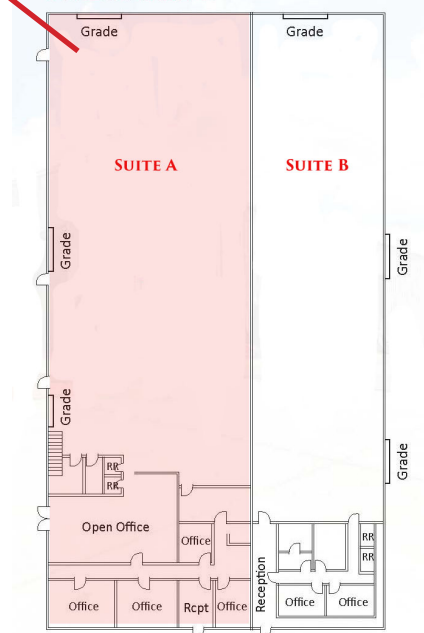

SAN DIEGO COMMERCIAL

TIM CLEPPER - PRESIDENT
380 S. MELROSE DR., SUITE 367, VISTA, CA 92081
TIM@SANDIEGOCOMMERCIAL.INFO
WWW.SANDIEGOCOMMERCIAL.INFO
CA BRE BROKER #: 01354303
C: 760.402.4846 T: 760.599.4200 F: 760.599.4344